

A513W Video Speaker Quick Installation Guide

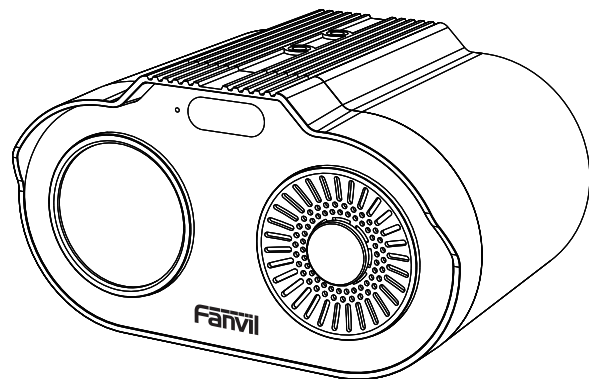

1 Package contents

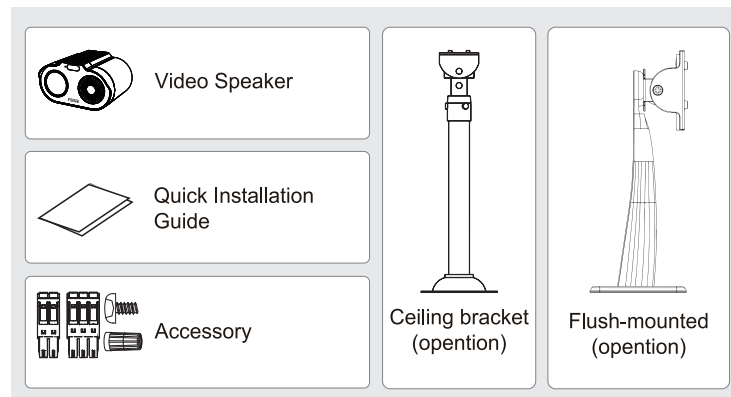

2 Physical specification

Model	A513W
Dimensions	176.04 × 100.02 × 130 (mm)

1) Dimensions

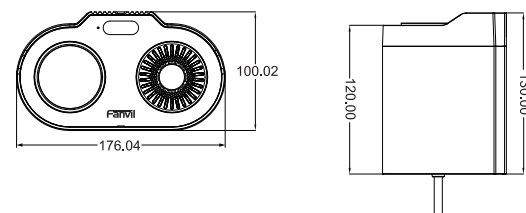

2) Panel

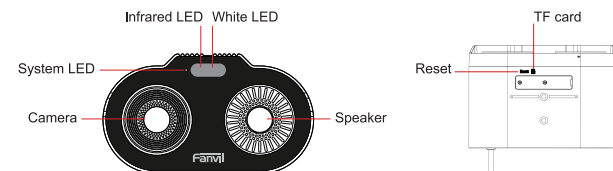

3) Interface description

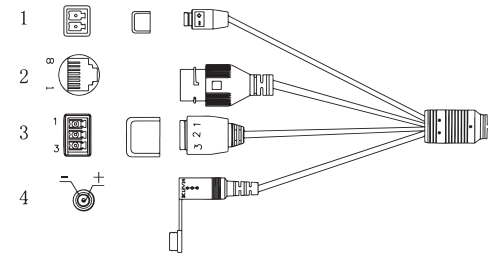

Serial number	Description	Wiring port description
1	The short circuit input interface: input devices for connecting switches, infrared sensor, door sensor, vibration sensors etc.	S1 GND
2	Ethernet interface: standard RJ45 interface, 10/100M adaptive, support PoE powered, it is recommended to use CAT5 or CAT5E network cable.	
3	The short circuit output interface: corresponding to the short-circuit input interface, login device web page settings, can be connected to electric locks, etc.	NO COM NC
4	Power interface: DC 12V-24V/2A input.	

3 External Device Connection Diagram

Model 1: DC Power

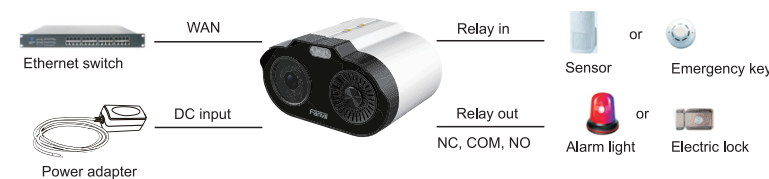

Model 2: POE Power

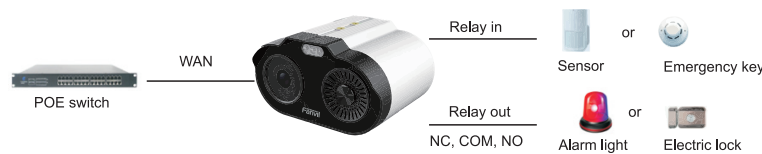

4 Installation diagram

Video Speaker have two installation methods: wall mounting and Ceiling Mount. Before installation, you need to purchase the corresponding accessories separately.

Wall-mounted (option):

- 1) Prepare the Mounting Bracket
Attach the bracket to the camera base by aligning the screw holes, Secure it with the provided screw(s). Hand-tighten firmly, Loosen the swivel knob and tilt knob on the bracket to allow free movement for later adjustment.

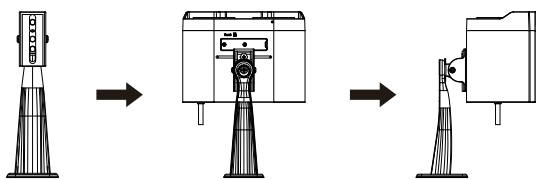

- 2) Mark Drill Holes
Peel the Mounting Template Sticker and attach it to your desired location (wall or ceiling), Mark the drill points and the cable exit hole clearly with a pencil.

- 3) Drill and Install Anchors
Drill holes using a 5mm diameter drill bit, Drill holes at the marked points to the required depth, Insert the provided wall plugs into the holes. Ensure they are flush with the surface.

- 4) Mount the Bracket
Align the bracket's base holes with the wall plugs, Secure the bracket using the provided screws. Fully tighten to ensure a firm hold.

- 5) Adjust Camera Angle
Route the camera cable (network/power) through the bracket and cable management slot. Connect the cable to the camera. Hold the camera and adjust it to the desired viewing angle by swiveling and tilting. While holding the perfect angle, tighten the swivel and tilt knobs securely to lock the position.

- 6) Final Check & Cable Management
Connect the power supply and the network cable. Use cable ties to neatly secure any loose cable to the bracket arm or nearby fixture.

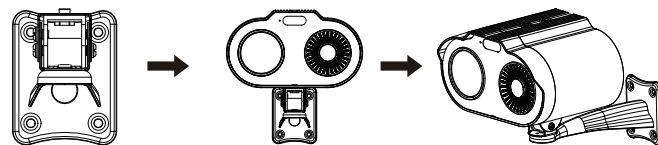

Ceiling Mounted (option):

- 1) Step 1: Prepare the Mounting Bracket
Attach the bracket to the camera base by aligning the screw holes, Secure it with the provided screw(s). Hand-tighten firmly, Loosen the swivel knob and tilt knob on the bracket to allow free movement for later adjustment.

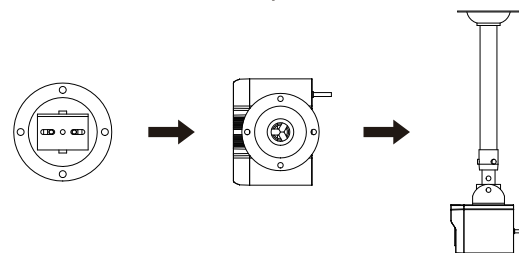

- Step 2: Mark Drill Holes
Place the lifting bracket at the designated installation location. Mark the drill points and the cable exit hole clearly with a pencil.

- 2) Drill hole
Drill holes using a 8mm diameter drill bit, Drill holes at the marked points to the required depth.

- 3) Mount the Bracket
Align the bracket's base holes with the wall plugs, Secure the bracket using the provided screws. Fully tighten to ensure a firm hold.

- 4) Adjust Camera Angle
Route the camera cable (network/power) through the bracket and cable management slot. Connect the cable to the camera. Hold the camera and adjust it to the desired viewing angle by swiveling and tilting. While holding the perfect angle, tighten the swivel and tilt knobs securely to lock the position.

- 5) Final Check & Cable Management
Connect the power supply and the network cable. Use cable ties to neatly secure any loose cable to the bracket arm or nearby fixture.

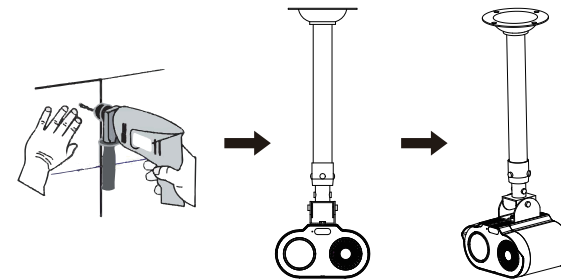

5 Searching IP address

Open the IP scanning tool (Device Manager), click on the Refresh button to obtain the IP address of the device within the local network.
(Download address <https://www.fanvil.com/service/doc/soft/tools/tools/ipscanner>)

MAC	IP Address	Model	Version	Version Status	Description
0c383e892e05	172.18.39.198	AS13W	2.20.0.2		AS13W
0c383e892e0d	172.18.39.208	AS13W	2.20.0.2		AS13W

6 Intercom configuration

Step 1: Log in the WEB admin interface of the device
Input IP address (e.g. <http://172.18.26.7>) into address bar of PC's web browser. The default user name and password are both admin.

Step 2: Add SIP account
【Line】 >> 【SIP】
Set SIP server address, port, username, password and SIP user with assigned SIP account parameters. Select click to take effect.

Step 3: Set the Intercom parameters
【Intercom Settings】 >> 【Media Settings】 >> 【Media Settings】 >> Set the volume of the device >> Click 【Apply】 to take effect.
Speakerphone Volume: Set the speaker output volume.
Handfree Mic Gain: Set the microphone volume.

Step 4: Set Call Button
【Call Button】 >> 【Call Button Settings】 >> Set speed dial parameters for Call Buttons >> Click 【Apply】 to take effect.
Type: Memory Button.
Value: The Call Button will dial to this Number 1.
Line: Working line.
Subtype: Speed Dial.

Step 5: Set the security function
【Security Settings】 >> 【Input Settings】 / 【Output Settings】
Two short circuits input and output configuration, trigger ring, tamper detection configuration.